

Residential Fences and Walls.

1. Height Limitations:

- a) In any residential "R" district, fences and walls not exceeding four (4) feet in height may be located within the required front yard.**
- b) In any residential "R" district, fences and walls not exceeding six (6) feet in height may be located within the required side and rear yards.**

2. Approved Residential Fence Materials

- a) Fences shall be constructed using materials commonly used for and suitable for residential-style fencing, including but not limited to, brick, stone, wrought iron, vinyl, chain link (with a top rail support), split rail with treated, stockade or board-on-board wood. **Finished side must face the adjoining property.**
- b) Used or reclaimed wood or other materials may be used provided they are in good condition and can be reasonably expected to last as long as new materials.
- c) Any part of a wood fence that touches concrete or contacts the ground must be pressure-treated wood or wood that is naturally resistant to decay and insects, such as cedar or redwood.
- d) Side or rear yard garden plots may use green garden fence, woven wire, or chicken wire provided it does not exceed five feet.

3. Prohibited Residential Fences and Materials. No person or property owner shall install:

- a) An electric, razor wire, barbed, chicken, woven, snow (except from November 1st through March 31), plastic safety, plastic garden, concrete block, or grapestake fence.
- d) A fence composed solely of fence posts.
- g) Agricultural fence products

4. Maintenance of Fences and Walls

Fences and walls shall be maintained in a manner as to prevent rust, corrosion and deterioration, so as not to become a public or private nuisance, and so as not to be dilapidated or a danger to adjoining property owners or the public. Fences and walls shall not create an appearance of patchwork, rust, or peeling paint which is indicative of a state of disrepair. Every fence and wall installed shall be maintained by the owner in such a way that it will remain plumb and in good repair.

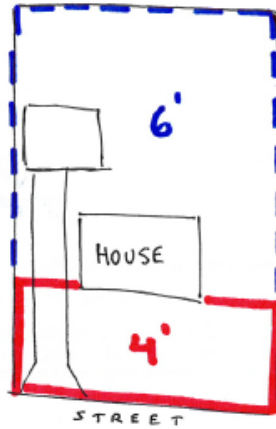

On a corner lot where required yards exist, no fence, wall, trees, shrubbery, sign or any other kind of structure or obstruction to vision with openings of less than seventy percent (70%) of its vertical surface area shall be erected, placed, planted, be allowed to grow, or be maintained between a height of two (2) feet and eight (8) feet above the established curb grade at the intersection of streets on the part of any yard located within the triangular zone formed by the intersecting property lines and a line connecting two (2) points on said property lines twenty (20) feet from their point of intersection.

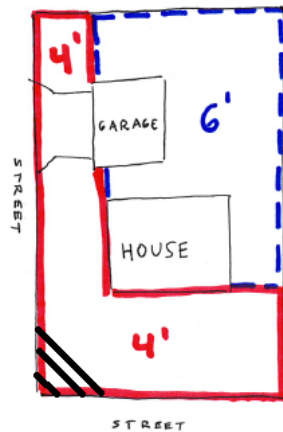
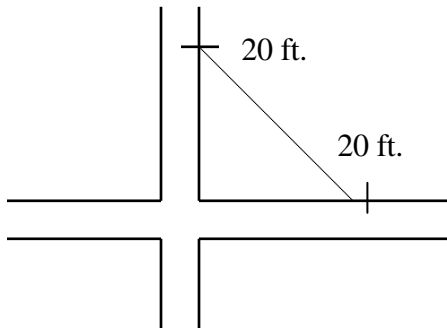

For a complete copy of all fence codes please contact the Zoning Office at 641-754-5756